

SOCIAL DISTANCED SEATING LAYOUT

Please refer to this plan for the correct layout of the room in adherence to social distancing guidelines.

Lecture Hall 2

↑ ONE WAY ARROWS

↑ ENTER ARROWS

↑ EXIT ARROWS

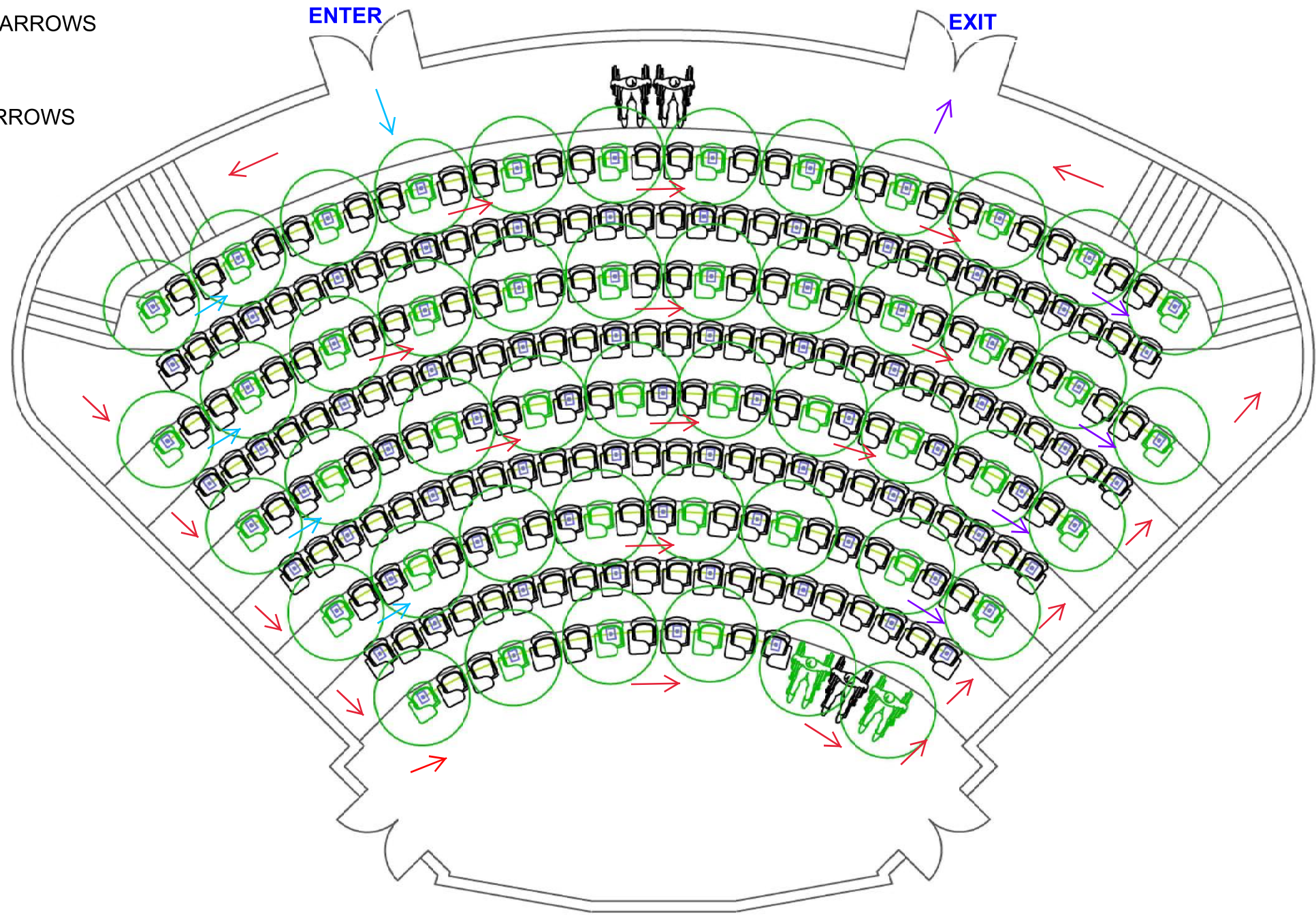

NEW CAPACITY

48

STUDENTS

FACE COVERINGS
REQUIRED.

PLEASE PRACTICE
SOCIAL
DISTANCING.

STAY 6 FEET APART

B

STAY SAFE

BINGHAMTON UNIVERSITY
STATE UNIVERSITY OF NEW YORK